

Flytrap Professional™

Flytrap Professional™ provides a professional and hygienic solution to insect control for sensitive areas such as food preparation areas. Designed to be the most effective professional unit on the market, Flytrap Professional™ gives 360° of light output and the simple glueboard and tube replacement makes Flytrap Professional™ extremely service friendly. Available as a 30, 40 or 80W unit in white metal or stainless steel, Flytrap Professional™ can be mounted by seven different methods providing the most flexible and versatile professional flykiller on the market.

PRODUCT CODE

ZF028

DESCRIPTION

FTP30, 30 watt, White

DIMENSIONS (MM) H x W x D

150 x 475 x 305

COVERAGE (M²)

80

TUBES

2 x TP15-18

GLUEBOARDS

1 x INF196

WEIGHT (KG)

4.0

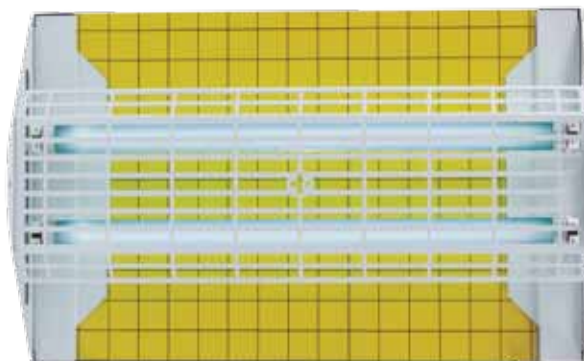

PRODUCT CODE

ZF031

DESCRIPTION

FTP30, 30 watt, Stainless

DIMENSIONS (MM) H x W x D

150 x 475 x 305

COVERAGE (M²)

80

TUBES

2 x TP15-18

GLUEBOARDS

1 x INF196

WEIGHT (KG)

4.0

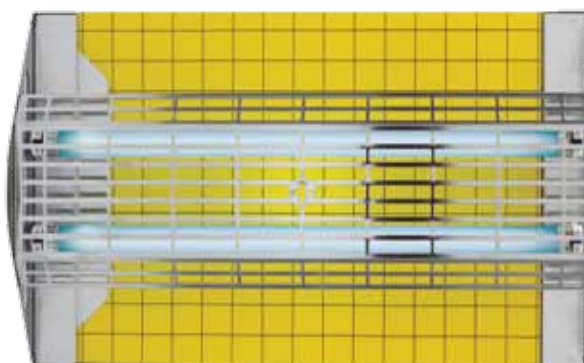

ROOM COVERAGE

80 m²

APPLICATION

Industrial Food
Preparation
Areas

PROFESSIONAL GLUEBOARD INSECT CONTROL



FEATURES

Choice of seven mounting options for maximum versatility

Simple glueboard and tube replacement

Provides 360° light output and ease of access for flying insects

Open design

Designed for use with GLUPAC® pheromone impregnated glueboards with UV stabiliser

High efficacy UV tubes

All metal construction – White metal or 304 grade stainless steel

Independently tested and certified to RoHS and relevant European standards

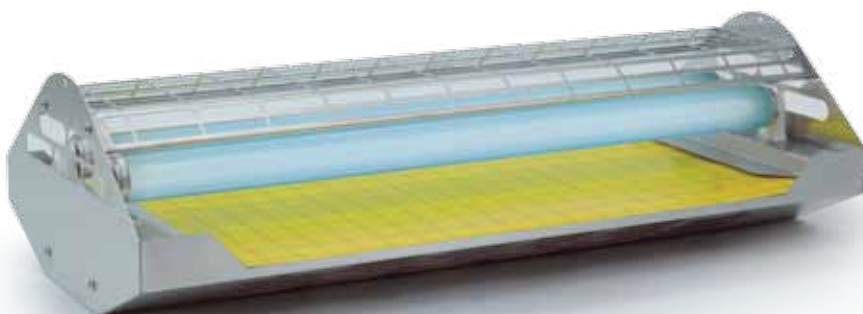

PRODUCT CODE

ZF032

DESCRIPTION

FTP40, 40 watt, Stainless

DIMENSIONS (MM) H x W x D

150 x 630 x 305

COVERAGE (M²)

120

TUBES

2 x TP20-24

GLUEBOARDS

1 x INF098

WEIGHT (KG)

5.5

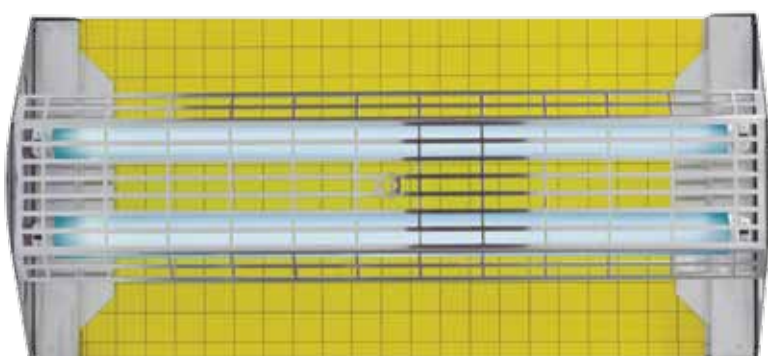

PRODUCT CODE

ZF033

DESCRIPTION

FTP80, 80 watt, Stainless

DIMENSIONS (MM) H x W x D

160 x 650 x 305

COVERAGE (M²)

240

TUBES

2 x TP40-24

GLUEBOARDS

1 x INF098

WEIGHT (KG)

5.5

ROOM COVERAGE

120 – 240 m²

APPLICATION

Industrial Food
Preparation
Areas

Flytrap Professional™

Professional Glueboard Insect Control

Please read these instructions carefully and store in a safe place for future reference.

FLYTRAP PROFESSIONAL™

As part of the **Insect-O-Cutor®** brand of insect control products, **Flytrap Professional™** is an effective and versatile professional flykiller which utilises highly effective UV tubes and is designed for use with a high specification glupac® glueboard. Three sizes of unit are available, all of which can be mounted by seven different methods, making it the most flexible professional flykiller on the market.

CONTENTS OF PACKAGE

- 1 x Flytrap Professional™ flykiller
- 1 x Glupac® pheromone impregnated glueboard
- 1 x Mains cable (Type X)
- 2 x High powered UV tubes (Fitted)
- 2 x Screws, wall plugs and suspension keyrings

WARNING - THIS APPLIANCE MUST BE EARTHED (CLASS 1)

INSECT CONTROL PRODUCTS

Flytrap Professional™ utilises high powered ultra violet tubes to attract flying insects and retains the caught insects on a pheromone impregnated glueboard for inspection or hygienic disposal.

WARNING

Flytrap Professional™ is not to be used by children or persons with reduced physical, sensory or mental capabilities, or lack of experience and knowledge, unless they have been given supervision or instruction.

Children should be supervised to ensure they do not play with the appliance.

If the mains cable is damaged it must be replaced by a specialist mains cable available from Pelsis Ltd or your supplier.

Not suitable for applications where potentially explosive environments may exist.

POSITIONING AND GUIDANCE FOR USING FLYTRAP PROFESSIONAL™

THIS UNIT IS FOR INDOOR USE ONLY. NOT SUITABLE FOR USE IN BARNs, STABLES & SIMILAR LOCATIONS.

Flytrap Professional™ should ideally be fixed around two meters above the ground, preferably in the darkest place within the area to be protected. **FOR HORIZONTAL WALL MOUNTING, ENSURE THERE IS A MINIMUM OF 350mm BETWEEN THE TOP OF THE FLYTRAP PROFESSIONAL™ AND THE CEILING TO PROVIDE ENOUGH SPACE TO INSERT THE GLUEBOARD (SEE MOUNTING INSTRUCTIONS.)** Do not position the unit close to windows, skylights or other sources of light, or where it may be obscured by furniture, doors or other obstacles. Ideally, **Flytrap Professional™** should be visible from every part of the area to be protected.

Flytrap Professional™ should ideally be in operation for 24 hours a day, ensuring your premises are kept free of flying insects. Insects are most attracted to **Flytrap Professional™** at night when there is no competition from daylight or other light sources.

GUARANTEE

Flytrap Professional™ has a three year guarantee and if maintained as recommended in these instructions should continue to work for many years.* Use of non-approved consumables may invalidate the guarantee. Ensure genuine glupac® glueboards are used in conjunction with this product.

*Excludes tubes, glueboards and starters. Does not cover breakdown due to misuse, incorrect operation or use in an incorrect application.

INSTALLATION

INSTALLATION SHOULD BE CARRIED OUT BY SERVICE PERSONNEL ONLY.

Flytrap Professional™ can be mounted in seven different ways as shown in the separate mounting options document. Keep out of the reach of children. For wall mounting, use the supplied wall mounting plugs and screws, making sure correct wall plugs are used for specialist mounting materials, such as plasterboard. Once installed in position, fit the glupac® glueboard in position as described in the glueboard replacement section of this document. Use the removable mains lead and plug to connect the **Flytrap Professional™** to an appropriate power supply.

CLEANING

CLEANING SHOULD BE CARRIED OUT BY SERVICE PERSONNEL ONLY, AFTER ENSURING THAT THE UNIT IS DISCONNECTED FROM THE MAINS SUPPLY.

It is recommended that cleaning is carried out regularly when the glueboard is replaced. Once the glueboard is removed, the unit should be thoroughly wiped down with a damp cloth, removing any build up of dirt. Ensure the unit is completely dry before reconnecting it to the power supply.

GLUEBOARD REPLACEMENT

BEFORE REPLACING THE GLUEBOARD, ALWAYS ENSURE THAT THE UNIT IS DISCONNECTED FROM THE MAINS SUPPLY.

The glueboard should be replaced every month with a genuine glupac® glueboard. Use of non-approved glueboards may invalidate your guarantee. **Flytrap Professional™** comes supplied with high efficacy yellow glueboards with printed grids for simple insect evaluation and monitoring. Discreet black replacement glueboards, which help hide the caught insects, are also available.

To replace the glueboard...

- 1. Remove the used glupac® glueboard by simply lifting it clear from the unit and either retain for catch evaluation or dispose of it hygienically.
- 2. Remove the protective release paper from the new glupac® glueboard.
- 3. Slowly slide the new glupac® glueboard into position along the two runners with the adhesive side facing the tubes.

Always ensure the selected genuine glupac® glueboards are compatible with your unit, available from your PCO or Pelsis Ltd.

TUBE REPLACEMENT

TUBE REPLACEMENT SHOULD BE CARRIED OUT BY SERVICE PERSONNEL ONLY, AFTER ENSURING THAT THE UNIT IS DISCONNECTED FROM THE MAINS SUPPLY.

To ensure the efficiency of **Flytrap Professional™** in catching flying insects, the UV tubes should be replaced annually. After twelve months the phosphor coating that emits the correct wavelength of UV light has burnt away and the UV output is diminished substantially.

To replace the UV tubes...

- 1. Rotate the tube through 90°, freeing it from the tube holders.
- 2. Pull the tube away from the chassis.
- 3. Dispose of the used UV tube in conjunction with local WEEE regulations.

STARTER REPLACEMENT

STARTER REPLACEMENT SHOULD BE CARRIED OUT BY SERVICE PERSONNEL ONLY, AFTER ENSURING THAT THE UNIT IS DISCONNECTED FROM THE MAINS SUPPLY.

The starters provide an extra spark to initially light the UV tubes. Starters wear out and should be replaced at the same intervals as the UV tubes.

To replace the starters...

- 1. Rotate the starter anti-clockwise.
- 2. Pull the starter free from the unit.

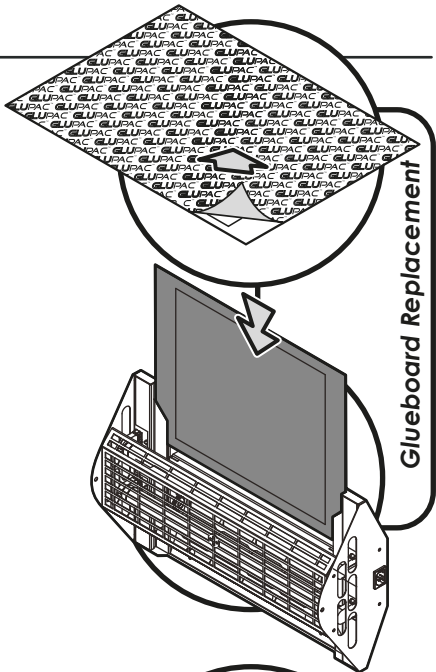

Glueboard Replacement

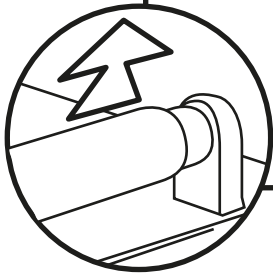
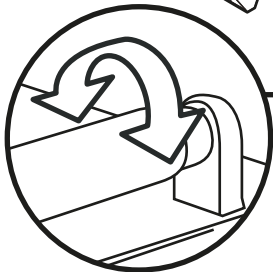

Tube Replacement

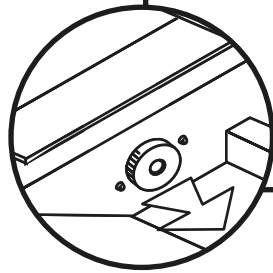
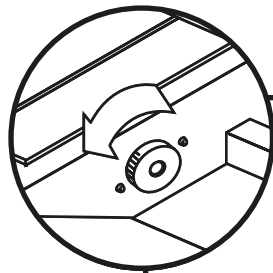

Starter Replacement

SPECIFICATION / REPLACEMENT PARTS					
Unit	FTP30	Unit	FTP40	Unit	FTP80
Voltage	230V ~ 50Hz	Voltage	230V ~ 50Hz	Voltage	230V ~ 50Hz
Dimensions(mm)	470 x 300 x 150	Dimensions(mm)	627 x 300 x 168	Dimensions(mm)	627 x 300 x 168
Coverage	80 Sq. Meters	Coverage	120 Sq. Meters	Coverage	240 Sq. Meters
Weight	4.5 Kg	Weight	6.0 Kg	Weight	6.1 Kg
Light Output	30W	Light Output	40W	Light Output	80W
Tubes	2 x TPX15-18	Tubes	2 x TPX18-24	Tubes	2 x TPX36-24
Starter	2 x I154	Starter	2 x I154	Starter	2 x I154
Glueboards (x6)	GB001 (Yellow) GB002 (Black)	Glueboards (x6)	GB011 (Yellow) GB012 (Black)	Glueboards (x6)	GB011 (Yellow) GB012 (Black)



Professional Glueboard Insect Control

